



# 4080 LOVALL VALLEY LOOP ROAD

SONOMA, CA 95476

Partial Lot Shown





# 4080 LOVALL VALLEY LOOP ROAD

SONOMA, CA 95476

Partial Lot Shown





# 4080 LOVALL VALLEY LOOP ROAD

SONOMA, CA 95476

Partial Lot Shown

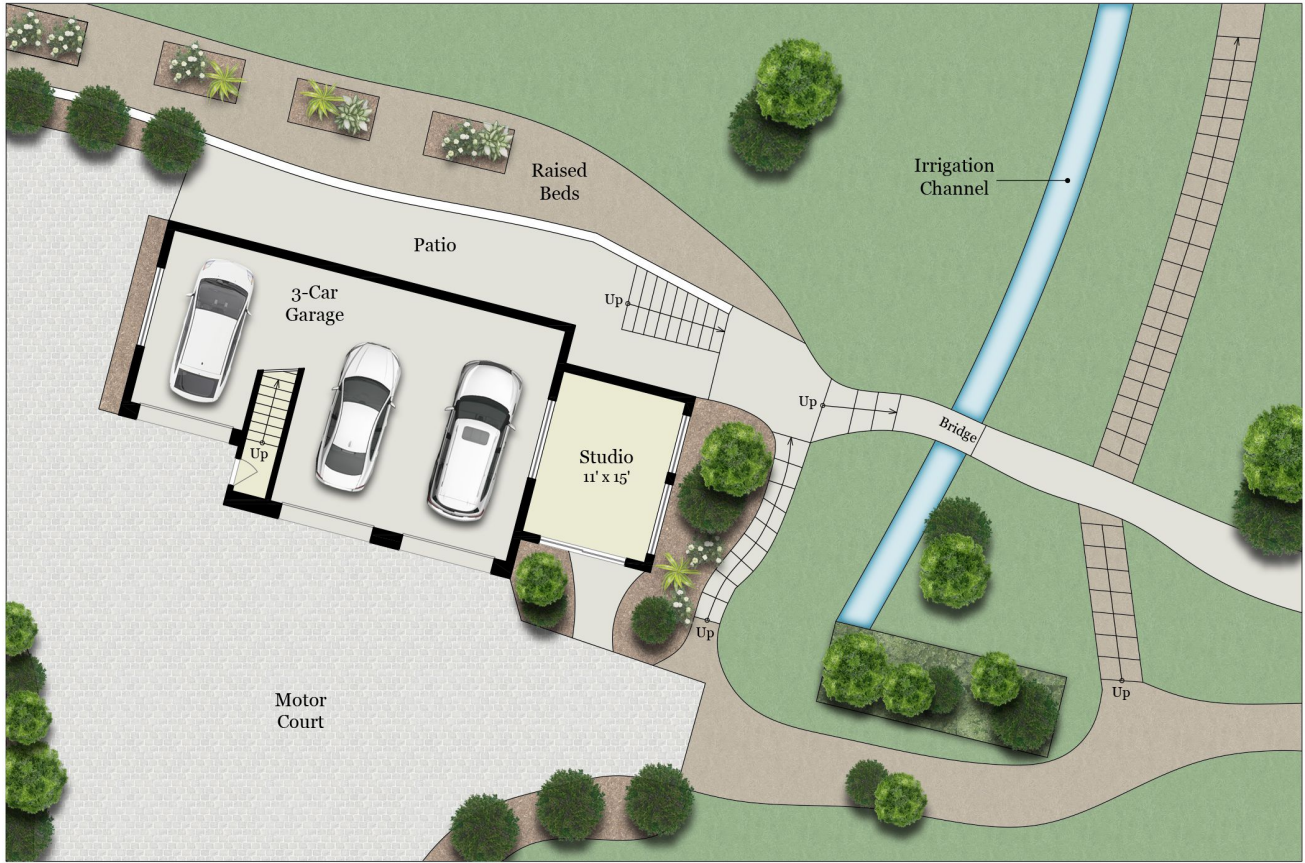

## GUEST HOUSE FIRST FLOOR

255 SQ FT - Finished  
750 SQ FT - Unfinished



## GUEST HOUSE SECOND FLOOR

795 SQ FT

## Estimated Total Finished Square Footage: 5,410 SQ FT

Above-Grade: 5,410 SQ FT Below-Grade: N/A

- Main Residence: 4,210 SQ FT
- Guest House: 1,050 SQ FT  
First Floor: 255 SQ FT  
Second Floor: 795 SQ FT
- Changing Room: 150 SQ FT

Plus 750 SQ FT 3-Car Garage (Guest House-First Floor)  
Plus 55 SQ FT Storage (Changing Room)  
Calculated per ANSI Standard Z765-2003

\* Estimated Total Finished & Unfinished Square Footage: 6,215 SQ FT



# 4080 LOVALL VALLEY LOOP ROAD

SONOMA, CA 95476

Partial Lot Shown

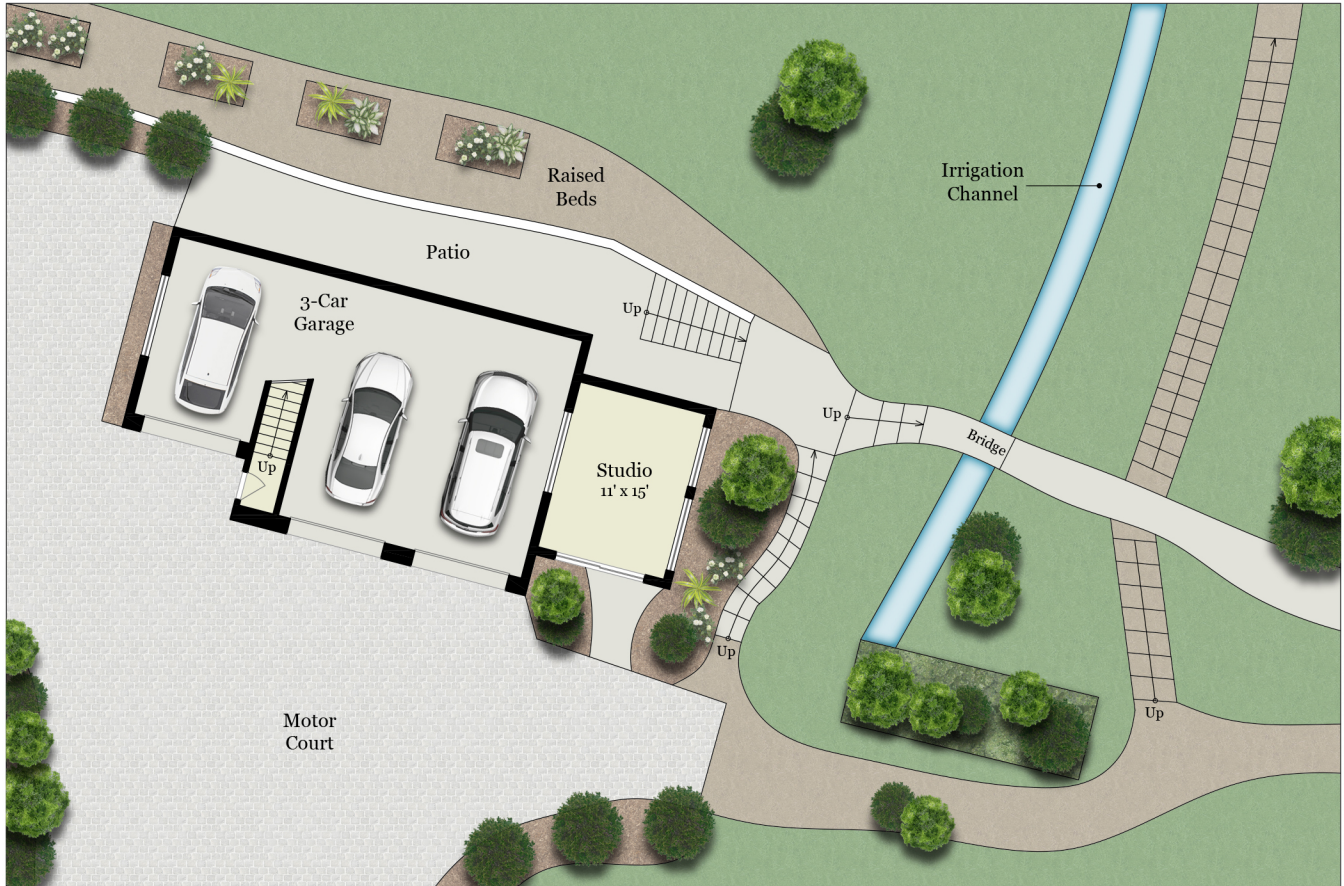

## GUEST HOUSE FIRST FLOOR

255 SQ FT - Finished  
750 SQ FT - Unfinished



## GUEST HOUSE SECOND FLOOR

795 SQ FT

## Estimated Total Finished Square Footage: 5,410 SQ FT

Above-Grade: 5,410 SQ FT Below-Grade: N/A

- Main Residence: 4,210 SQ FT
- Guest House: 1,050 SQ FT  
First Floor: 255 SQ FT  
Second Floor: 795 SQ FT
- Changing Room: 150 SQ FT

Plus 750 SQ FT 3-Car Garage (Guest House-First Floor)

Plus 55 SQ FT Storage (Changing Room)

Calculated per ANSI Standard Z765-2003

\* Estimated Total Finished & Unfinished Square Footage: 6,215 SQ FT

# 4080 LOVALL VALLEY LOOP ROAD

SONOMA, CA 95476

## SITE PLAN



# 4080 LOVALL VALLEY LOOP ROAD

SONOMA, CA 95476

## SITE PLAN

